



relationships **FORGED**
solutions **CAST**

U.V. International, LLC

360 Mt. Kemble Ave. Suite#2000, Morristown, NJ 07960

Ph: (973) 775 1660 | F: (973) 775 1680

uvnj@uvintl.com | www.uvintl.com

Ductile Iron Back Up Flanges (IPS)

Ref: DBUF1021

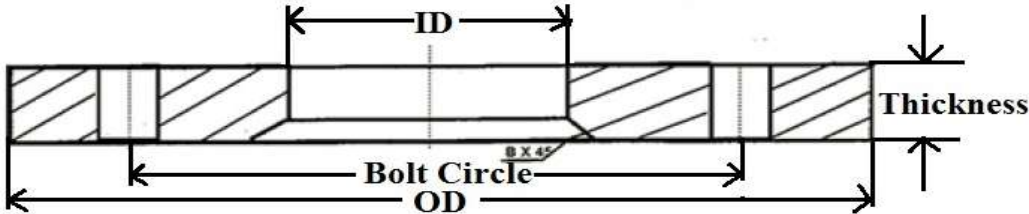

Item Number	Nom. Pipe Size	ID (Inner Diameter)	OD (Outer Diameter)	Flange Thickness	Bolt Circle	Bolt Hole Diameter	Bevel B45	Bolt Size	No. of Holes
DBUF0050	1/2"	0.900	3.500	0.438	2.375	0.622	0.188	0.500	4
DBUF0075	3/4"	1.110	3.875	0.500	2.750	0.622	0.188	0.500	4
DBUF0100	1"	1.380	4.250	0.500	3.125	0.622	0.188	0.500	4
DBUF0125	1 1/4"	1.720	4.625	0.500	3.500	0.622	0.188	0.500	4
DBUF0150	1 1/2"	1.960	5.000	0.500	3.875	0.622	0.188	0.500	4
DBUF0200	2"	2.437	6.000	0.500	4.750	0.750	0.250	0.625	4
DBUF0250	2 1/2"	2.940	7.000	0.500	5.500	0.750	0.250	0.625	4
DBUF0300	3"	3.563	7.500	0.500	6.000	0.750	0.250	0.625	4
DBUF0400	4"	4.563	9.000	0.563	7.500	0.750	0.250	0.625	8
DBUF0500	5"	5.625	10.000	0.625	8.500	0.875	0.250	0.750	8
DBUF0600	6"	6.750	11.000	0.625	9.500	0.875	0.250	0.750	8
DBUF0800	8"	8.750	13.500	0.625	11.750	0.875	0.313	0.750	8
DBUF1000	10"	10.875	16.000	0.625	14.250	1.000	0.313	0.875	12
DBUF1200	12"	12.875	19.000	0.750	17.000	1.000	0.313	0.875	12

*Dimensions are in inches.

- ▶ Ductile Iron ASTM A536 (65-45-12)
- ▶ Beveled Inner Diameter
- ▶ Drilled: ANSI B16.5 - Class 150
- ▶ Coating: Bare / Red Primer Paint / Galvanized

**Please send your orders to orders@uvintl.com or
call (800) 848-6884**